

SuperPan® Tech P6 EZ

Technical data sheet

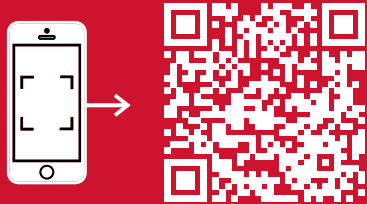

Wooden Construction and Sustainability

It contributes to the circular economy, and promotes sustainable forest management while ensuring socio-economic development in rural communities.

Aligned with the European Union efforts to reduce harmful man-made contaminants and emissions.

It has the following benefits:

- Captures and stores CO₂
- Low thermal conductivity
- Very low formaldehyde emissions



Finsa

finsa.com

Finsa Tech

SuperPan® Tech P6 EZ

Very high-strength construction board for mezzanine floors

finsa.com

Construction board technical class P6

Classified as a P6 technical class structural board, high performance structural board for dry environments, it is a unique solution in the structural board market.

1

2

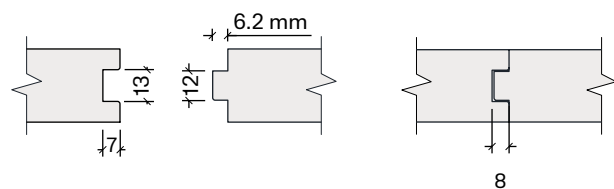

1. Tongue and groove detail of SuperPan® Tech P6 EZ TG 30 mm thick.

2. Butt joint. The tongue and groove joint of the 30 mm thick SuperPan® Tech P6 EZ TG itself leaves a 0.8 mm gap.

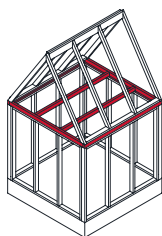
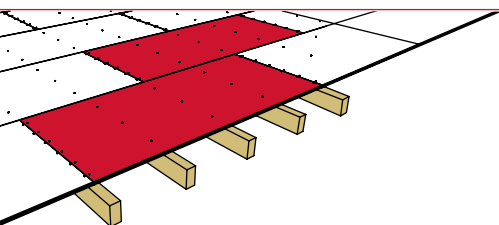

Span Calculations



Available to our customers is the Finsa Span Calculation software, for calculating floor and roof structures. This provides design guidance for compliance with CTE DB-SE-M for specification of both boards and beams.

SuperPan® Tech P6 EZ boards are suitable for service class 1 and use class 1 in accordance with standard EN 312.



Bfl-s1/B-s2,d0

- SuperPan® Tech P6 EZ Decor B
Anti-slip Gris I



Bfl-s1

- SuperPan® Tech P6 EZ Decor
(With anti-slip Gris I and anti-slip Granitech)

Installation recommendations



Standard pack sizing

Model	Format	Thickness
SuperPan® Tech P6 EZ TG2L	2400 x 590	38
SuperPan® Tech P6 EZ TG4		
SuperPan® Tech P6 Decor EZ TG2L Blanco Super 1C		
SuperPan® Tech P6 Decor EZ TG4 Blanco Super 1C		
SuperPan® Tech P6 Decor EZ TG2L Gris I Anti-slip Blanco		
SuperPan® Tech P6 Decor EZ TG4 Gris I Anti-slip Blanco Super		

Advantages

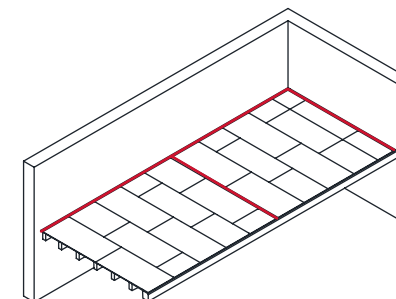
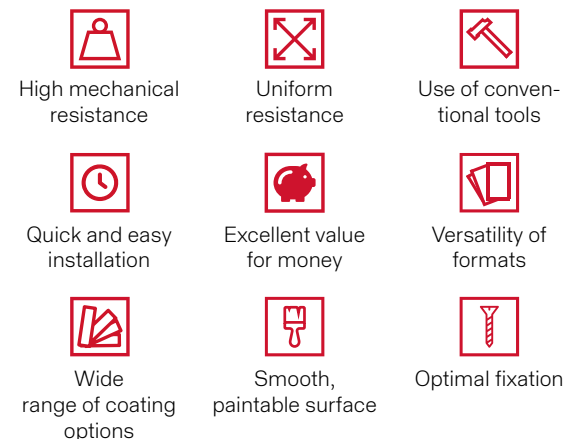

Applications

- Construction of industrial mezzanines
- Construction of timber frames
- Storage platforms and industrial shelving
- Renovation and renewal of spaces
- Residential construction
- Innovative building systems